

EBCI IDD/Autism Project Update



IDD/AUTISM COMMUNITY  
ENGAGEMENT & OUTREACH  
SUBCOMMITTEE

FEBRUARY 23, 2026

# Overview



- Project Timeline
- Gaps and Needs Identified
- Project Goals
- Enrichment Resource Center Functions
- FFY 2026 Project Plan
  - Completed
    - Preferred Providers Services
  - In Progress
    - Renovation Schematic
    - Assessments Workflow
    - Tribal IDD Population
    - Care Management Roles and Supports
    - Services and Supports for Individuals with IDD
    - IDD Service Benefit
- Resource Needs and Future Steps
- Success Story
- Contact Info and Questions

# The IDD Project Creation Timeline



- Oct. 2019 Resolution #4 passed
- Aug. 2021 Gaps and Needs Assessment began
- Sept. 2022 Gaps and Needs Assessment Report completed (Access, Residential, Meaningful Day, Medical, Transportation, Regulatory, Financial, Education/Outreach)
- Sept. 2024 Tribal Council listening sessions on lack of services, housing, long wait times
- Nov. 2024 IDD/Autism Steering Committee formed
- Jan. 2025 Full implementation of IDD/Autism Project
- April 2025 Subcommittees began to meet
- Aug. 2025 RFI for Preferred Providers released
- Sept. 2025 Transfer of project from PHHS to CIHA
- Nov. 2025 CIHA Governing Board approved project
- Dec. 2025 Project restructuring began
- Jan. 2026 IDD Director interviews began; RFI Provider interviews; Provider visits began

# Gaps and Needs Identified

- Access
  - Long wait times for assessments
  - Long wait times for services
  - Availability of specialized therapies, medical care, and habilitation supports
  - Availability of Dual dx options (MH/SU and IDD)
  - Availability of Respite
- Lack of meaningful day options utilizing best practices
  - Employment
  - Recreation
  - Habilitation supports and services
- Lack of residential options as individuals transition to adulthood and aging
- Lack of transportation options
- Coordination among agencies with established roles and responsibilities
- Knowledge about the IDD system of supports/services and philosophy of practices of self-advocacy and self-direction
- No Tribal entity that owns IDD policy and oversight
- Lack of Tribal Providers offering supports and services to individuals

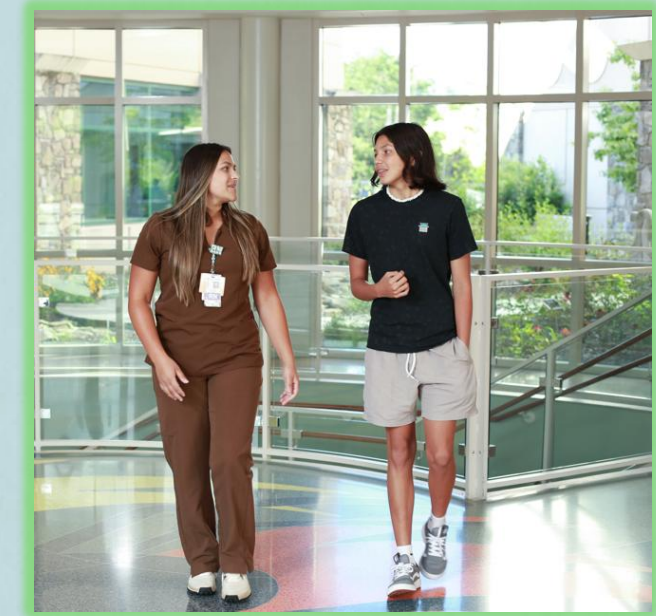

# EBCI IDD/Autism Project Goals



1. Develop Tribal **infrastructure** for an EBCI IDD/Autism Program including a mission, vision and operating principles for the EBCI IDD/Autism program.

2. Create a family resource center within the EBCI IDD/Autism Enrichment Center that is a place of knowledge, resources and supports within the tribe and the region.

3. Create tribal system of care and supports for and with individuals with IDD/Autism including housing options, timely access for assessments, meaningful day options, robust care management and respite continuum.

4. Develop competencies, focusing on a tribal workforce, to manage and operate EBCI IDD/Autism services and supports.

# EBCI IDD/Autism Enrichment Resource Center Functions

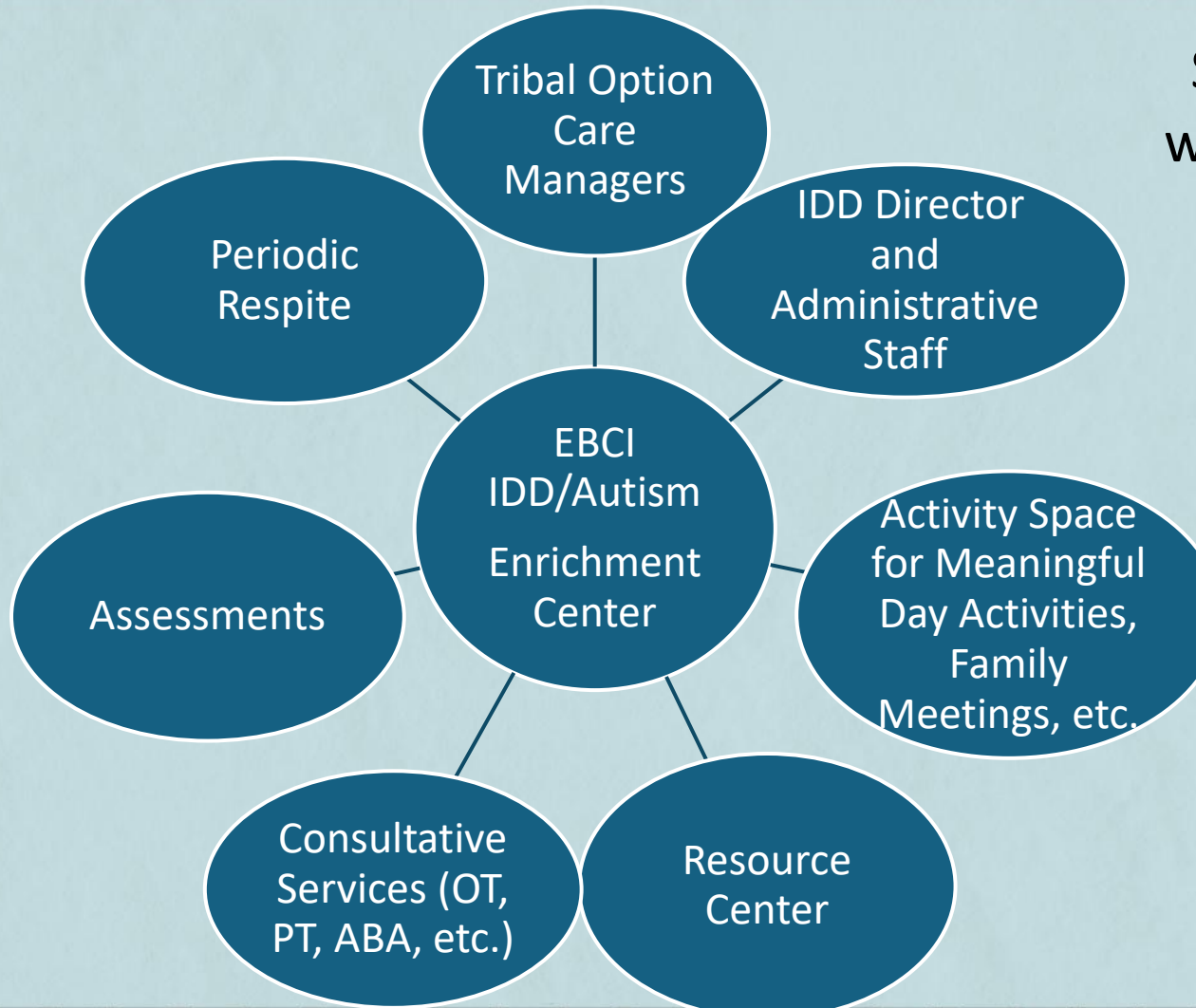

Services do not have to wait until the Enrichment Center is opened.



# Completed FFY 2026 Project Plan

- Visited IDD service providers across the state
- Funded FFY 2026 budget
- Job descriptions are graded
- IDD Director position posted and interviews in progress
- EBCI IDD/Autism Steering Committee Charter updated
- Selected preferred providers for the provider network
- Completed Person Centered Thinking/Planning training



# Preferred Providers Services



	In Home Respite	Out of Home Respite	Crisis Respite	Navigator	Alternative Family Living	Residential Supports	Special Consultative Services	Long Term Community Supports	Personal Care Services	Day Program/Community Integration	Supported Living	Community Living and Supports	Research Based Tx (ABA)	Supported Employment	Community Transition	Other
Amivie	X				X	X		X	X	X	X	X		X		
Community Alternatives	X	X	X	X	X	X	X	X	X	X	X	X	X			
Abound	X	X	X		X	X	X			X	X			X	X	
All Ways Caring	X	X	X	X					X		X	X		X		
Voices Together																Music Therapy



# In Progress FFY 2026 Project Plan



- Hire Leadership and staff
- Finalize schematic of Enrichment Center
- Finalize assessments process workflows (for understanding and communication)
- Implement services in partnership with external service providers (Respite, Supported Living, Vocational, ABA(Applied Behavior Analysis)/RBT(Research Based Therapy), and 1915i services)
- Complete framework and definitions for IDD Tribal Code
- Complete regulatory requirements for services and supports
- Educate the community about IDD Care Management
- Begin to operationalize the Enrichment Center facility
- Develop FFY 2027 project plan
- Develop FFY 2027 budget



# Enrichment Center Renovation Schematic

## (IDD) ENRICHMENT CENTER PROJECT

- Project meeting with CIHA, EBCI, and the design team occurred on 1/23/26. Next meeting is scheduled for 2/24/26. Ongoing detailed discussions of the layout are occurring (yellow comments on the adjacent floorplan).
- The project team hopes to wrap up the design phase in May of 2026.

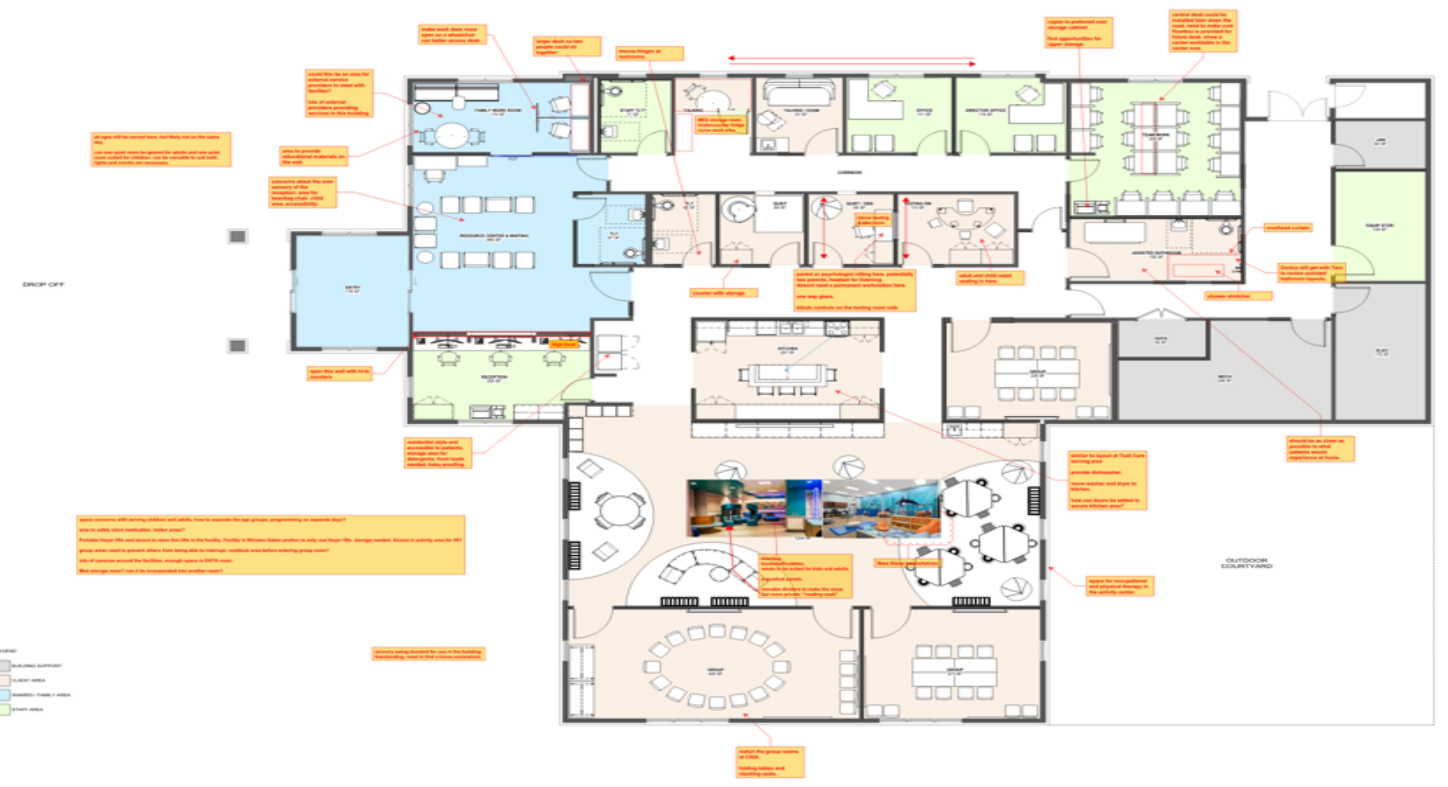



# In Progress FFY 2026 Project Plan (Con't)

- External Providers will begin to deliver periodic services (respite, meaningful day activities)
- External Providers and/or Tribal partners will offer 10 residential placements to include supported living, host home, alternative family living
- CIHA provider IDD diagnostic assessments will be implemented and expanded
- Enrichment Center renovation with target opening in March 2027
- Tribal Option Care Managers providing coordination of services for 300+ IDD population, including 8 Innovations Waiver individuals and 37 1915i individuals
- Continued training for care managers, staff, and other community stakeholders (IDEA, Service Definitions, Person Centered Planning/Thinking, workflows, Money Follows the Person, Guardianship, etc.)
- Developing EBCI/CIHA IDD provider/workforce strategy



# The Tribal IDD Population

388 people identified as having one or more  
IDD Diagnoses

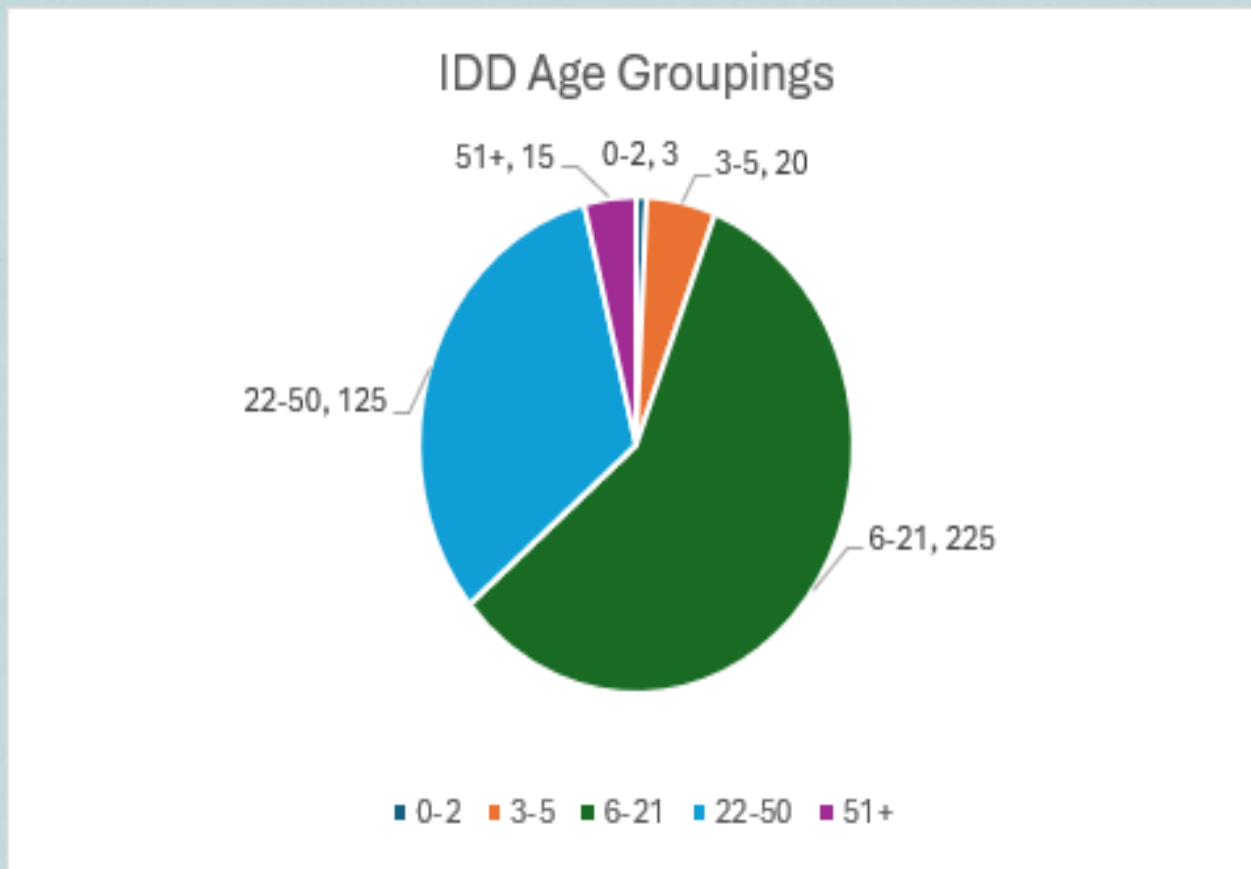
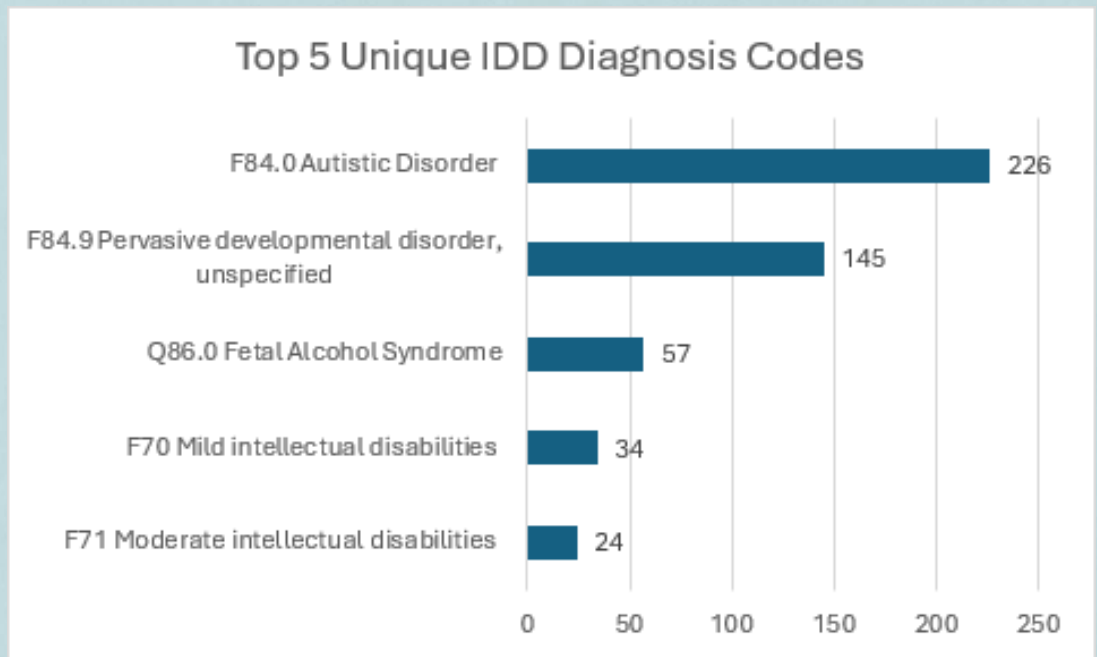

# Care Management Roles and Supports



# Care Management Teams



**IDD/LTSS Team**  
Serving members who have IDD and LTSS needs

**Foster and LTSS Team**  
Serving members who are now or previously been in foster care and those with only LTSS needs



**Adults and Children with Special Health Care Needs Team**  
Serving members who have behavioral health needs, high risk pregnancy and high risk children

**Medical Team**  
Serving members who may or may not have complicated medical health needs and do not need any assistance from the other teams

# Services and Supports for People with Intellectual and Developmental Disabilities



- Community Living & Supports
- Community Transitions
- Respite Care
- Residential Supports
- Assistive Technology
- Home Modifications
- Supported Living
- Long-Term Community Supports
- Residential Services – Complex Needs
- Personal Care Services
- Supported Employment
- Community Networking
- Community Navigator
- Day Supports
- Benefits Counseling
- Specialized Consultation
- Crisis Services
- Natural Supports Education
- Research-Based Behavioral Health Treatment for Autism Spectrum Disorder

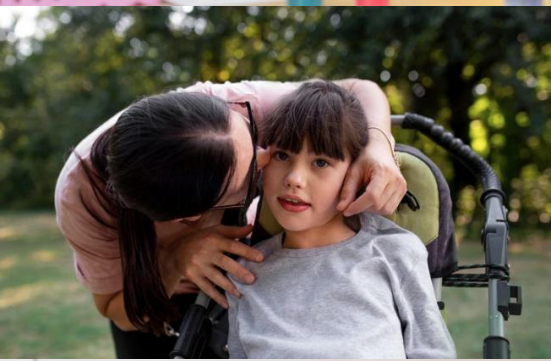
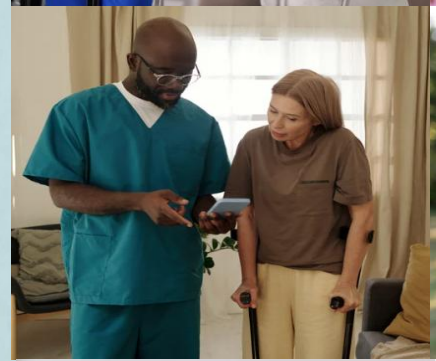

# IDD Service Benefit

- Care Management is the key for planning and accessing services and supports
- Funding options and services have criteria associated with them
- In addition to diagnostic assessments, services such as the 1915i services or Personal Care services require an assessment by the NC DHHS Independent Assessment Entity.
- Services are designed to be community-based with the push to be LESS facility/clinic-based
- Most individuals with IDD receive multiple services and sometimes across the funding sources
- Supports and services are
  - HCBS Waivers: Innovations, CAP-C, and CAP-DA
  - 1915i
  - In-Lieu of Services (ILOS)/B-3
  - Medicaid Direct
  - State Funds



# Resource Needs and Future Steps

- Increased staff competencies for supporting individuals with IDD, such as:
  - Specialized therapies (OT, PT, Speech) with assistive devices, customization of equipment, augmentative communication, special equipment
  - Targeted areas for training (Self – Direction, IDEA, best practices for supports, guardianship, etc.)
  - Knowledge about the Medicaid benefit package
- New partnership and contracting with other entities
- Funding for non-Medicaid covered services
- Coordination among all Tribal agencies and communities to accomplish the goals and determine roles and responsibilities in the IDD System of Supports
- Workforce development
- Annual review of 5-year project plan with adjustment for the upcoming year as the IDD System evolves and goals are achieved

# CONTACT INFO AND QUESTIONS



Dr. Freida Saylor, Director of Behavioral Health and IDD Services

[Freida.saylor@cherokeehospital.org](mailto:Freida.saylor@cherokeehospital.org)

Office-828 497 9163 x7551

Karen Kennedy, EBCI Tribal Option Director

[Karen.kennedy@cherokeehospital.org](mailto:Karen.kennedy@cherokeehospital.org)

Office- 828 497 9163 x 6297

Cell- (828) 788 6274

To Be Determined, IDD Director

[XXXX@cherokeehospital.org](mailto:XXXX@cherokeehospital.org)

Office-828 497 9163 x

Cansler Collaborative Resources(CCR), Consultant & IDD Project Experts

Kara Froberg, [kfroberg@ccr-email.com](mailto:kfroberg@ccr-email.com)

Tara Larson, [tlarson@ccr-email.com](mailto:tlarson@ccr-email.com)

